

**QUELL**

---

**Ionisation  
Sealed Smoke Alarm with  
Ten Year Lithium Battery & Hush**  
.....**Manual**  
.....**Model Q910**

Ionisation smoke alarms are designed to detect invisible particles (associated with fast flaming fires). Home fires develop in different ways and are often unpredictable. For maximum protection against fast flaming fires and slow smouldering fires, both ionisation and photoelectric alarms should be installed.

Manual P/N 130418  
0910-7215-04

## CONTENTS

**IMPORTANT! READ ALL INSTRUCTIONS BEFORE INSTALLATION AND KEEP THIS MANUAL NEAR THE ALARM FOR FUTURE REFERENCE**

INTRODUCTION.....	1
INSTALLATION.....	2-8
OPERATION.....	9-10
MAINTENANCE.....	11-12
FIRE SAFETY.....	13-15
WARRANTY & CONTACT DETAILS.....	16-17



Manufactured in China for:  
 Chubb Fire & Security Pty Ltd  
 149-155 Milton Street,  
 Ashfield NSW 2131 Australia  
**Telephone:** 1800 654 435  
**Website** [www.quell.com.au](http://www.quell.com.au)

This smoke alarm uses an extremely small amount of radioactive element in the ionisation chamber (see warning on page 18). Do not try to repair the smoke alarm yourself. Refer to the instructions in the warranty section.

### INTRODUCTION

Models Q910

If you have any questions about the operation or installation of your alarm, please call 1800 654 435. Image 1C will help you determine the correct location of safety products that will help make your home a safer place.

## INSTALLATION

---

### RECOMMENDED LOCATIONS

- Install the first alarm in the immediate area of the bedrooms. Try to protect the exit path as the bedrooms are usually farthest from the exit. If more than one sleeping area exists, install additional alarms in each sleeping area (Image 1A).
- Install additional alarms to protect any stairway as stairways act like chimneys for smoke and heat.
- Install at least one alarm on every floor level (Image 1B).
- Install an alarm in every bedroom where a smoker sleeps.
- Install an alarm in every room where large electrical appliances are operated (i.e. portable heaters or humidifiers).
- Install an alarm in every room where someone sleeps with the door closed. The closed door may prevent the alarm from waking the sleeper.
- Smoke, heat and combustion products rise to the ceiling and spread horizontally. Mounting the smoke alarm on the ceiling in the centre of the room places it closest to all points in the room. Ceiling mounting is preferred in ordinary residential construction.
- For mobile home installation, select locations carefully to avoid thermal barriers that may form at the ceiling. For more details, see MOBILE HOME INSTALLATION on page 4.
- When mounting an alarm on the ceiling, locate it at a minimum of 30cm (12") from the side wall and 2 feet (61cm) from any inside corner Image 2A.
- When mounting the alarm on the wall, use an interior wall with the top edge of the alarm at a minimum of 10cm (4") and a maximum of 30cm (12") below the ceiling, and at least 2 feet (61cm) from any inside corner Image 2A.
- Put smoke alarms at both ends of a bedroom hallway or large room if the hallway or room is more than 9.1m (30 feet) long.

## INSTALLATION

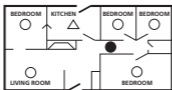

- Smoke Alarms for Minimum Protection
- Smoke Alarms for Additional Protection
- △ Ionization Type Smoke Alarms with "Hush" Control or Photoelectric Type

SINGLE FLOOR PLAN

IMAGE 1A

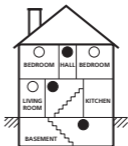

MULTIPLE FLOOR PLAN

IMAGE 1B

- Install smoke alarms on sloped, peaked or cathedral ceilings between 500 and 1500mm from the highest point of the ceiling. Smoke alarms in rooms with ceiling slopes greater than 1 m in 8 m horizontally should be located on the high side of the room (See Image 2B).

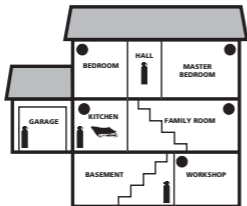

IMAGE 1C

TOTAL HOME PROTECTION



## INSTALLATION

---

### MOBILE HOME INSTALLATION

Mobile homes built in the past five to seven years have been designed to be energy efficient. Install smoke alarms as recommended above (refer to RECOMMENDED LOCATIONS and Image 2A).

In mobile homes that are not well insulated compared to present standards, extreme heat or cold can be transferred from the outside to the inside through poorly insulated walls and roof. This may create a thermal barrier which can prevent the smoke from reaching an alarm mounted on the ceiling. In such units, install the smoke alarm on an inside wall with the top edge of the alarm at a minimum of 10cm (4") and a maximum of 30cm (12") below the ceiling (see Image 2A).

If you are not sure about the insulation in your mobile home, or if you notice that the outer walls and ceiling are either hot or cold, install the alarm on an inside wall. For minimum protection, install at least one alarm close to the bedrooms. For additional protection, see SINGLE FLOOR PLAN in Image 1A.

**WARNING: TEST YOUR SMOKE ALARM OPERATION AFTER CARAVAN OR MOBILE HOME VEHICLE HAS BEEN IN STORAGE, BEFORE EACH TRIP AND AT LEAST ONCE A WEEK DURING USE.**

## INSTALLATION

---

### Locations to Avoid

- Do not install within 0.9 m (3 ft) of the following: The door to a kitchen, or a bathroom that contains a tub or shower, forced air supply ducts used for heating or cooling, ceiling or whole house ventilating fans, or other high air-flow areas.
- Do not place the alarm where curtains or other objects will block the sensor. Smoke must be able to reach the sensor to accurately detect conditions.
- Install at least 30cm (12 in) away from fluorescent lights as electronic noise may cause nuisance alarms.
- Keep out of insect infested areas. Avoid excessively dusty, dirty or greasy areas. Dust particles may cause nuisance alarms or failure to alarm.
- Extreme temperatures may effect the sensitivity of the alarm. Do not install in areas where the temperature is colder than 5°C or hotter than 45°C, such as garages and unfinished attics.
- Do not install in areas where the relative humidity (RH) is greater than 85%. Very humid areas, with moisture or steam, can cause nuisance alarms.
- Avoid placing smoke alarms in kitchen areas. Normal cooking may cause nuisance alarms. If a kitchen alarm is desired, it should have an alarm silencer feature or be a photoelectric type.
- Do not place in the garage. Particles of combustion are present when you start your automobile.
- Smoke alarms are not to be used with detector guards unless the combination (alarm and guard) has been evaluated and found suitable for that purpose.
- In dead air spaces such as the peak of an "A" frame ceiling. "Dead Air" at the top may prevent smoke from reaching the alarm in time to provide early warning. Refer to images 2A and 2B.

## INSTALLATION

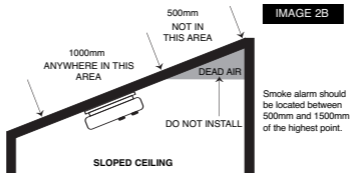
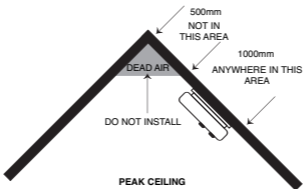
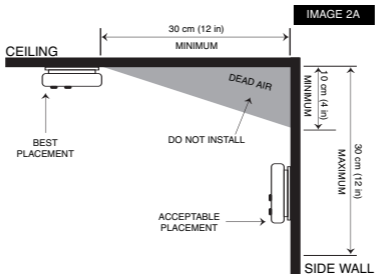

## INSTALLATION

### INSTALLATION INSTRUCTIONS

**CAUTION: THIS UNIT IS SEALED (INCLUDING THE BATTERIES). THE COVER IS NOT REMOVABLE!**

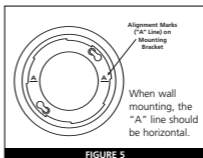
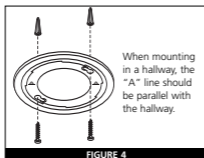

1. To ensure aesthetic alignment of the alarm with the hallway or wall, the "A" line on the mounting bracket should be parallel with the hallway when ceiling mounting or horizontal when wall mounting.

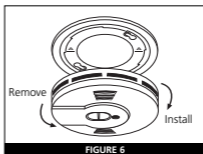

2. After selecting the proper smoke alarm location as described previously, attach the mounting bracket to the ceiling as shown in Image 2A and Figure 4. Place the mounting plate on the wall; be sure the "A" line is horizontal (parallel to the floor). Use the screws and cavity fixings provided to secure the mounting bracket (use 3/16" drill bit for wall plugs).
3. This alarm has batteries permanently sealed inside the alarm so no battery installation or maintenance is necessary.

### ACTIVATING THE ALARM

This model is equipped with a feature that automatically activates the alarm when the alarm is mounted to the mounting bracket for the first time. Once activated, the batteries will supply power to the alarm for the life of the alarm (10 years). Be sure that the mounting bracket is mounted correctly before installing the alarm on the mounting bracket.



## INSTALLATION

1. To activate the alarm, install the alarm on the mounting bracket (Figure 6) and rotate the alarm clockwise (as indicated on the alarm cover) until the alarm ratchets into place (the ratcheting function allows for aesthetic alignment). NOTE: The alarm will mount to the bracket in four (4) positions (every 90 degrees).

**The alarm is now activated!**

2. After installation/activation, test your alarm by depressing and holding down the test button for a minimum of 5 seconds (or until the alarm sounds). This should sound the alarm. **CAUTION: Due to the loudness (85 decibels) of the alarm, always stand an arms length away from the unit when testing.**

## TAMPER RESIST FEATURE

### Smoke Alarm Tamper Resist Feature

To make the smoke alarm tamper-resistant, a tamper resist feature has been provided. To activate this feature you must break out the 4 tamper-resist blocks on the mounting plate (see figure 7A). Use a small screw driver.

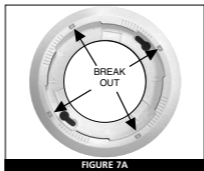

The tamper resist feature will deter children and others from removing the alarm from the bracket. NOTE: To remove the alarm when the tamper resist tab is engaged, press down on the tamper resist tab and rotate the alarm anti-clockwise in the direction indicated by the arrows on the cover of the alarm (see Figure 7B).

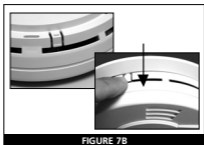

## OPERATION

### OPERATION AND TESTING

The smoke alarm is operating once the alarm is activated (see Installation Instructions) and testing is complete. When products of combustion are sensed, the unit sounds a loud 85db pulsating alarm until the air is cleared. If there is any question as to the cause of the alarm, it should be assumed that the alarm is due to an actual fire and the dwelling should be evacuated immediately.

**HUSH™ CONTROL:** The HUSH™ feature has the capability of temporarily desensitising the alarm circuit for approximately 8 minutes. This feature is to be used only when a known alarm condition, such as smoke from cooking, activates the alarm. The smoke alarm is desensitised by pushing the HUSH® button on the smoke alarm cover. If the smoke is not too dense, the alarm will silence immediately and the red LED will flash slowly (1.5 seconds on - 8 seconds off) for 8 minutes. This indicates that the alarm is in a temporarily desensitised condition. The smoke alarm will automatically reset after approximately 8 minutes. If after this period particles of combustion are still present, the alarm will sound again. The HUSH™ feature can be used repeatedly until the air has been cleared of the condition causing the alarm. Pushing the test/reset button on the alarm will end the temporarily desensitised period.

**NOTE: DENSE SMOKE WILL OVERRIDE THE HUSH™ CONTROL FEATURE AND SOUND A CONTINUOUS ALARM..**

**CAUTION: BEFORE USING THE ALARM HUSH™ FEATURE, IDENTIFY THE SOURCE OF THE SMOKE AND BE CERTAIN A SAFE CONDITION EXISTS.**

#### LED Indicator

This alarm is equipped with a red LED indicator, with four modes of operation.

**Red LED - Flashing every 40-45 seconds:** Indicates that the smoke alarm is receiving power and operating properly.

**Red LED - Flashing (1.5 second on - 1.5 second off):** When the smoke alarm senses particles of combustion and goes into alarm (constant pulsating sound), the red LED will flash (approximately one flash per second). The flashing LED and pulsating alarm will continue until the air is cleared.

**Red LED - Flashing slowly (1.5 seconds on - 8 seconds off):** Indicates that the unit is in the Hush mode.

**Red LED - Flashing rapidly when the test button is pressed:** This unit features an "alarm memory" to inform you if the alarm has sounded since the test button was last pressed. The alarm memory will cause the red LED to flash rapidly when the test button is pressed. The alarm memory is reset when the test button is released.

**TESTING:** Test by pushing the test button on the cover and holding it down for a minimum of 5 seconds (or until the alarm sounds). This will sound the alarm if the electronic circuitry, horn, and batteries are working. If no alarm sounds, the unit has defective batteries or other failure. **DO NOT** use an open flame to test your alarm, you could damage the alarm or ignite combustible materials and start a structure fire.

**NOTE: WEEKLY TESTING IS REQUIRED.**

**TEST THE ALARM WEEKLY TO ENSURE PROPER OPERATION.** Erratic or low sound coming from your alarm may indicate a defective alarm, (see Warranty section).

## OPERATION

---

### NUISANCE ALARMS

Smoke alarms are designed to minimise nuisance alarms. Combustion particles from cooking may set off the alarm if the alarm is located close to the cooking area. Large quantities of combustible particles are generated from spills or when grilling/frying. Using the fan on a range hood which vents to the outside (non-recirculating type) will also help remove these combustible products from the kitchen.

This model Q910 has a HUSH™ control that is extremely useful in areas prone to nuisance alarms. For more information refer to OPERATION AND TESTING SECTION.

If the alarm does sound, check for fires first. If a fire is discovered, get out and call the fire brigade. If no fire is present, check to see if one of the reasons listed in installation section "locations to avoid" may have caused the alarm.

## MAINTENANCE

### BATTERY ACTIVATION AND DEACTIVATION

**NOTE:** Three Lithium-Ion batteries, permanently sealed inside the alarm, power this unit; no battery installation or replacement is necessary for the life of the alarm.

**WARNING! DO NOT ATTEMPT TO OPEN THE ALARM FOR ANY REASON!**

To activate the alarm, attach the alarm to the mounting bracket by rotating clockwise in the direction of the arrows on the cover, see **ACTIVATING ALARM** in (INSTALLATION INSTRUCTIONS).

This alarm has a low battery monitor circuit which will cause the alarm to "chirp" approximately every 40-45 seconds, for a minimum of thirty (30) days, at the end of the life of the alarm to indicate that the alarm needs replacement. To deactivate the alarm remove the alarm from the mounting bracket by rotating the alarm anti-clockwise in the direction indicated by the arrows on the cover of the alarm and locate the crosshatched area on the product label. **NOTE: TAMPER RESIST FEATURE** in (INSTALLATION INSTRUCTIONS Section). Explains how to remove alarm from base.

**WARNING! DO NOT DEACTIVATE THE ALARM UNTIL THE END OF THE ALARM LIFE, WHEN A "CHIRP" IS HEARD EVERY 40-45 SECONDS. ONCE THE ALARM IS DEACTIVATED THE BATTERIES WILL BE DEPLETED AND THE ALARM WILL NO LONGER FUNCTION.**

**WARNING! ONCE THE ALARM HAS BEEN DEACTIVATED, IT CANNOT BE REACTIVATED!**

**WARNING! ONCE THE ALARM HAS BEEN DEACTIVATED, IT CANNOT BE MOUNTED ONTO THE MOUNTING BRACKET!**

Break out the crosshatched area with a screwdriver or similar tool. Using a screwdriver or similar tool slide the exposed piece towards the centre of the alarm. This will deactivate the alarm, stop the low battery "chirp" and render the alarm safe for disposal by draining the batteries.



## MAINTENANCE

---

### CLEANING YOUR ALARM

#### YOUR ALARM SHOULD BE VACUUMED ONCE A MONTH

You will need to follow the instructions in Installation Section to remove your alarm for maintenance.

To clean your alarm, remove it from the mounting bracket as outlined in the beginning of this section. You can clean the interior of your alarm (sensing chamber) by using compressed air or a vacuum cleaner hose and blowing or vacuuming through the openings around the perimeter of the alarm. The outside of the alarm can be wiped with a damp cloth.

After cleaning, reinstall your alarm and test your alarm by using the test button. If cleaning does not restore the alarm to normal operation the alarm should be replaced. Do not paint the unit. Paint will seal the vents and interfere with the sensor's ability to detect smoke. Never attempt to disassemble the unit or clean inside. This action will void your warranty.

#### Alarm Removal

Refer to the Alarm Tamper Resist Feature section for removal instructions.

To remove the alarm from the mounting plate, rotate the alarm anti-clockwise in the direction of the "OFF" arrow on the cover.

**WARNING:** Do not attempt to open the alarm for any reason!

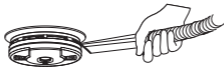

## FIRE SAFETY

---

### LIMITATIONS OF SMOKE ALARMS

#### WARNING: PLEASE READ CAREFULLY AND THOROUGHLY

- Australian Standard AS 1670.6 states the purpose of installing smoke alarms is to provide early warning of a potentially life threatening condition and provide the maximum possible exit time.
- Smoke alarms are devices that can provide early warning of possible fires at a reasonable cost; however, alarms have sensing limitations. Ionisation sensing alarms may detect invisible fire particles (associated with fast flaming fires) sooner than photoelectric alarms. Photoelectric sensing alarms may detect visible fire particles (associated with slow smouldering fires) sooner than ionisation alarms. Home fires develop in different ways and are often unpredictable. For maximum protection, Chubb recommends that both Ionisation and Photoelectric alarms be installed.
- Smoke alarms must be tested regularly to make sure the batteries and the alarm circuits are in good operating condition.
- Smoke alarms cannot provide an alarm if smoke does not reach the alarm. Therefore, smoke alarms may not sense fires starting in chimneys, walls, on roofs, on the other side of a closed door or on a different floor.
- If the alarm is located outside the bedroom or on a different floor, it may not wake up a sound sleeper.
- The use of alcohol or drugs may also impair one's ability to hear the smoke alarm. For maximum protection, a smoke alarm should be installed in each sleeping area on every level of a home.
- Although smoke alarms can help save lives by providing an early warning of a fire, they are not a substitute for an insurance policy. Home owners and renters should have adequate insurance to protect their lives and property.

### GOOD SAFETY HABITS

#### DEVELOP AND PRACTICE A PLAN OF ESCAPE

- Install and maintain fire extinguishers on every level of the home and in the kitchen, basement and garage. Know how to use a fire extinguisher prior to an emergency.
- Make a floor plan indicating all doors and windows and at least two (2) escape routes from each room. Second storey windows may need an escape ladder.
- Have a family meeting and discuss your escape plan, showing everyone what to do in case of fire.
- Determine a place outside your home where you all can meet if a fire occurs.
- Familiarise everyone with the sound of the smoke alarm and train them to leave your home when they hear it.
- Practice a fire drill at least every six months, including fire drills at night. Ensure that small children hear the alarm and wake when it sounds. They must wake up in order to execute the escape plan. Practice allows all occupants to test your plan before an emergency. You may not be able to reach your children. It is important they know what to do.

## FIRE SAFETY

---

### WHAT TO DO WHEN THE ALARM SOUNDS

- Alert small children in the home.
- Leave immediately by your escape plan. Every second counts, so don't waste time getting dressed or picking up valuables.
- In leaving, don't open any inside door without first feeling its surface. If hot, or if you see smoke seeping through cracks, don't open that door! Instead, use your alternate exit. If the inside of the door is cool, place your shoulder against it, open it slightly and be ready to slam it shut if heat and smoke rush in.
- Stay close to the floor if the air is smoky. Breathe shallowly through a cloth, wet if possible.
- Once outside, go to your selected meeting place and make sure everyone is there.
- Call the Fire Brigade by dialling 000 from your neighbour's home - not from yours!
- Don't return to your home until the fire officials say that it is all right to do so.

There are situations where a smoke alarm may not be effective to protect against fire. For instance:

- a) smoking in bed
- b) leaving children home alone
- c) cleaning with flammable liquids, such as gasoline

## FIRE SAFETY

---

### Additional Information

Smoke Detection - Where required by applicable laws, codes, or standards for the specified occupancy, approved single and multiple-station smoke alarms shall be installed as follows: (1) In all sleeping rooms exception: Smoke alarms shall not be required in sleeping rooms in existing one and two-family dwelling units. (2) Outside of each separate sleeping area, in immediate vicinity of the sleeping rooms. (3) On each level of the dwelling unit, including basements exception: In existing one and two-family dwelling units, approved smoke alarms powered by batteries are permitted.

Smoke Detection - Are more smoke alarms desirable? The required number of smoke alarms might not provide reliable early warning protection for those areas separated by a door from the areas protected by the required smoke alarms. For this reason, it is recommended that the householder consider the use of additional smoke alarms for those areas for increased protection.

The additional areas include the basement, bedrooms, dining room, furnace room, utility room, and hallways not protected by the required smoke alarms. The installation of the smoke alarms in the kitchen, attic (finished or unfinished), or garage is normally not recommended, as these locations occasionally experience conditions that can result in nuisance alarms.

Notify your local fire brigade and insurance company of your smoke alarm installation.



## WARRANTY & CONTACT DETAILS

### TEN YEAR LIMITED WARRANTY

#### Warranty

Chubb warrants to the original consumer purchaser that each new smoke alarm will be free from defects in materials and workmanship under normal use for a period of 10 years from the date of purchase.

Chubb agrees to repair or replace (at our discretion) any defective smoke alarm upon presentation of the proof of purchase. The benefits to the consumer given by this warranty are in addition to other rights and remedies of the consumer under the Australian Consumer Law and other applicable laws relating to the product.

Our goods come with guarantees that cannot be excluded under the Australian Consumer Law. You are entitled to a replacement or refund for a major failure and compensation for any other reasonably foreseeable loss or damage. You are also entitled to have the goods repaired or replaced if the goods fail to be of acceptable quality and the failure does not amount to a major failure.

#### Exclusions

Subject to non-excludable laws, this warranty does not cover:

- normal wear and tear to the product or parts
- batteries or other consumables included with this product (excluding sealed non replaceable battery models)
- damage to the product caused by accidents, misuse, abuse, lack of reasonable care, tampering or repair by a person not authorised by Chubb
- any product that has not been installed, operated or maintained in accordance with the manual or operating instructions provided with the product
- any damage caused by improper power input or improper cable connection
- any indirect, special or consequential loss or damage of any kind

#### To make a claim

If a defect in the product appears within the time frame stated, you are entitled to submit a warranty claim by returning your product to the address shown below. Please contact Chubb on telephone number: 1800 654 435 (opening hours: Mon - Fri 9:00AM to 5:00PM AEST). When returning the product, please ensure it is properly packaged so that no damage occurs during transit. Any postage and packaging expenses required to return the product to Chubb will be at your cost.

Please provide the original or a copy of the proof of purchase. Also, please make sure you have included an explanation of the problem.

If Chubb elects to repair the product, please note that goods presented for repair may be replaced by refurbished goods of the same type rather than being repaired. Refurbished parts may be used to repair the goods.

## WARRANTY & CONTACT DETAILS

---

This warranty is provided by:

Chubb Fire & Security Pty Ltd ACN 000 067 541  
149-155 Milton Street, Ashfield NSW 2131 Australia  
Telephone: 1800 654 435  
Website: [www.quell.com.au](http://www.quell.com.au)

Chubb New Zealand Limited  
3 Fisher Crescent, Mt Wellington, Auckland, New Zealand  
Telephone: 09 270 7288  
Website: [www.quell.co.nz](http://www.quell.co.nz)



AS 3786 Lic 1377  
SAI Global

**WARNING:** Radioactive material Americium 241 1.0 microcuries. Do not tamper with sealed source. When this alarm is no longer required, it's recommended that the preferred method of disposal for small numbers of Smoke Alarms is to include them in the domestic rubbish.